

|   |  |               |  |
|---|--|---------------|--|
| Project Name                                    |  | Customer Name |  |
| Quote Number                                    |  | Date          |  |
| Available in Left or Right Wall/Seat Placement* |  |               |  |
| Customization                                   |  |               |  |

\*Wall/seat placement determined as if standing outside the unit looking in

### Standard Features

|                            |  |
|----------------------------|--|
| <b>Type</b>                | Two-piece alternate roll-in type shower stall with simulated 12" x 24" tile. Available in left or right hand configuration |
| <b>Color</b>               | White  |
| <b>Exterior Dimensions</b> | 63"W x 39"D x 79-5/8"H   |
| <b>Materials</b>           | Gel coat and fiberglass composite  |
| <b>Approximate Weight</b>  | 175 lbs  |

### Certifications and Accessibility Code Compliance



Uniform Plumbing Code



CSA B45.5-11 / IAPMO Z124-2017



ADA

ANSI

ICC A117.1 - 2017 ANSI Type A



California Title 24

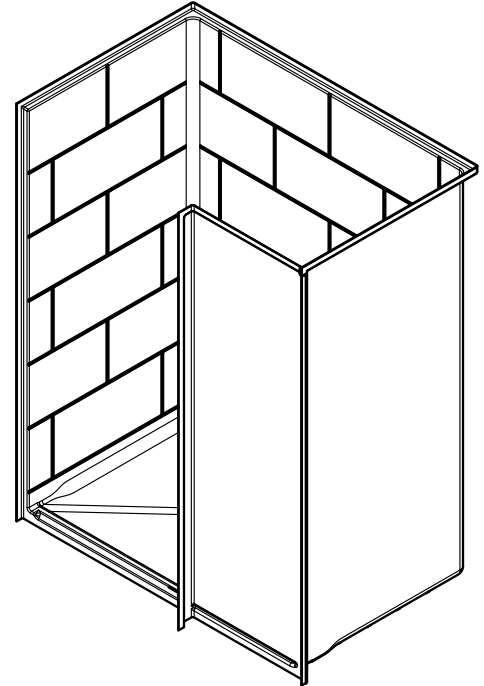

### Warranty

30 Year Limited

### Reinforcement

Fully reinforced with EverFab's unique composite core material which allows for factory or field installation of ADA compliant grab bars and seat

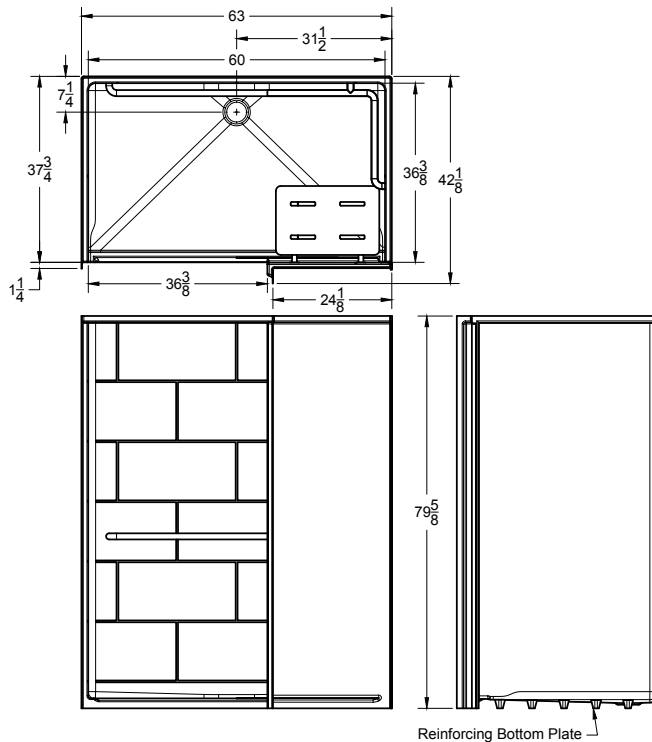

Due to the nature of the material, all measurements may vary by  $\pm 3/8"$ .  
Dimensions needed for site preparation should be measured from the unit.

## ADA Accessory Dimensions

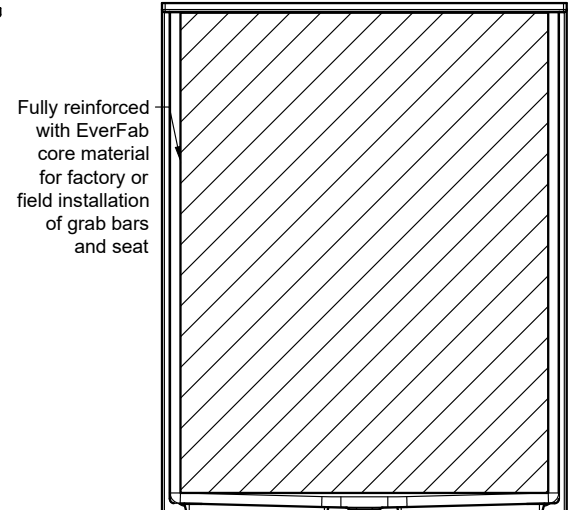
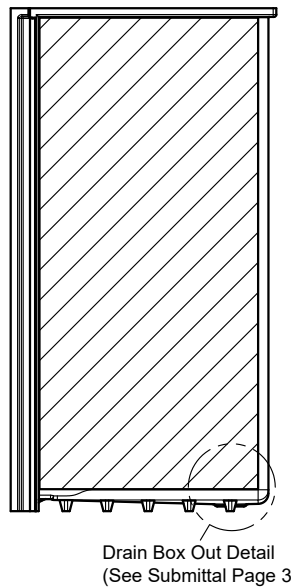
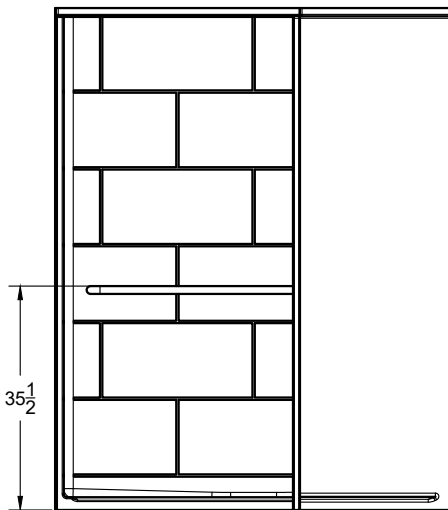
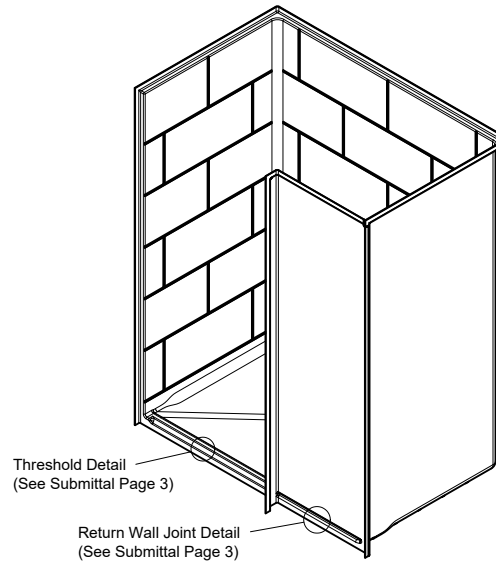
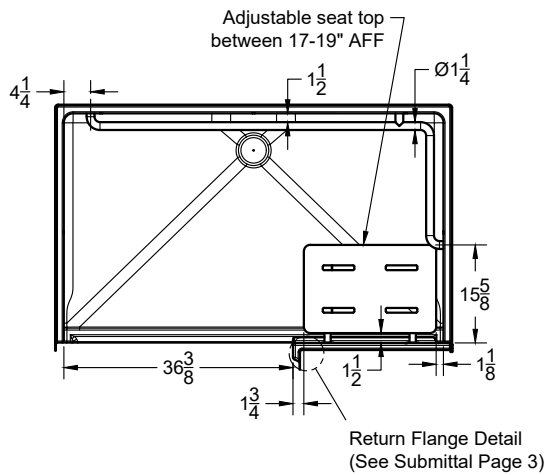

## Architectural Specifications

### A. Shower Stall:

1. Model: No. S6339RWTA-L/R
2. Description: Two-piece shower stall with reinforcing bottom plate, slip-resistant floor, return wall, 1/8" interior drop for water retention, 12" x 24" simulated tile, and inorganic composite reinforcement for placement of grab bars and seat
3. Exterior dimensions: 63 inches wide x 39 inches deep x 79-5/8 inches high
4. Threshold: [Standard] [Low Profile] [No Recess] Threshold Detail
5. Accessory Configuration: Model [A0] [A1]
6. Optional Accessories: Furnish with [curtain rod], [shower curtain], [recessed soap dish], [rubber dam], [stainless steel semi-permanent threshold], [shower slide-bar kit], [EverFab tub-wrap], [shower drain]

**ADA Accessory Configurations (number following 'A' indicates configuration)**

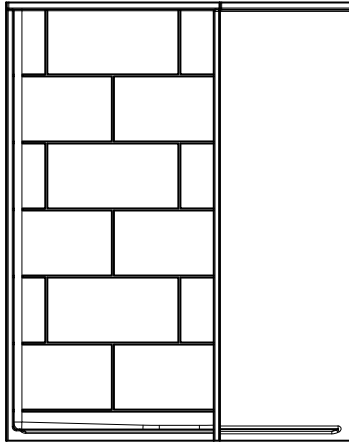

**S6339RWT A0-R**

No Accessories

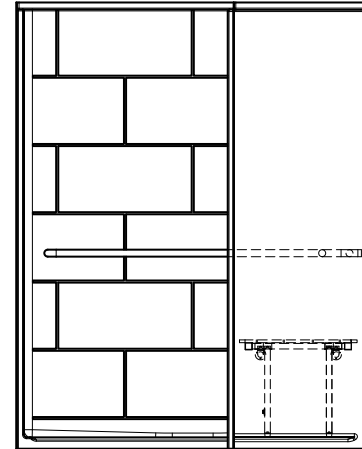

**S6339RWT A1-R**

L-shaped grab bar  
Seat

**Threshold Details**

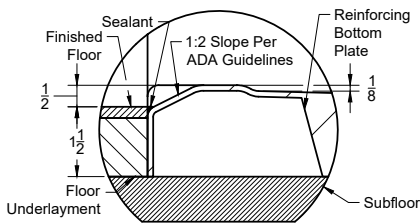

**Standard**

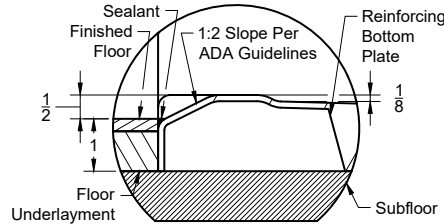

**Low-Profile**

*Model number followed with 'LP'*

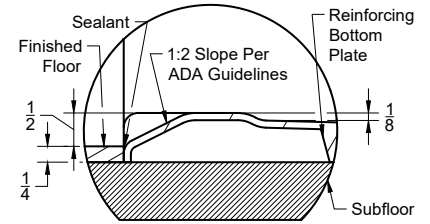

**No-Recess**

*Model number followed with 'NR'*

**Additional Details**

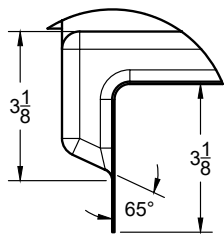

**Return Flange**

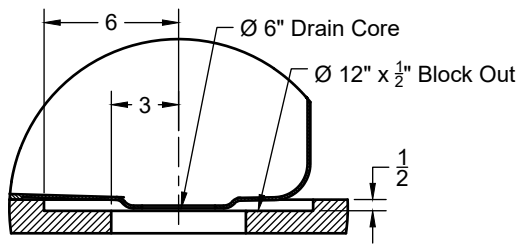

**Drain Block-Out**

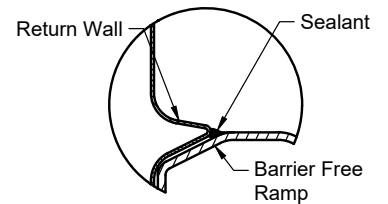

**Return Wall Joint**

## Standard Threshold Model Configurations

| Model Number                        | Pre-Installed L-Shaped Grab Bar | Pre-Installed Folding Seat | Drain Block Out Required | Accessibility Code Compliance        |
|-------------------------------------|---------------------------------|----------------------------|--------------------------|--------------------------------------|
| <input type="checkbox"/> S6339RWTA0 | No                              | No                         | No                       | Adaptable**                          |
| <input type="checkbox"/> S6339RWTA1 | Yes                             | Yes                        | No                       | ADA, CA Title 24, WAC, ANSI, HUD/FHA |

## Low Profile Threshold Model Configurations

| Model Number                          | Pre-Installed L-Shaped Grab Bar | Pre-Installed Folding Seat | Drain Block Out Required | Accessibility Code Compliance        |
|---------------------------------------|---------------------------------|----------------------------|--------------------------|--------------------------------------|
| <input type="checkbox"/> S6339RWTA0LP | No                              | No                         | Yes                      | Adaptable**                          |
| <input type="checkbox"/> S6339RWTA1LP | Yes                             | Yes                        | Yes                      | ADA, CA Title 24, WAC, ANSI, HUD/FHA |

## No-Recess Threshold Model Configurations

| Model Number                          | Pre-Installed L-Shaped Grab Bar | Pre-Installed Folding Seat | Drain Block Out Required | Accessibility Code Compliance        |
|---------------------------------------|---------------------------------|----------------------------|--------------------------|--------------------------------------|
| <input type="checkbox"/> S6339RWTA0NR | No                              | No                         | Yes                      | Adaptable**                          |
| <input type="checkbox"/> S6339RWTA1NR | Yes                             | Yes                        | Yes                      | ADA, CA Title 24, WAC, ANSI, HUD/FHA |

\*\*Model is reinforced and capable of meeting accessibility code requirements with proper field-installation of grab bars and seat

## Seat Placement (indicated by '-L' or '-R' following model number if applicable)\*

- Left Hand  Right Hand

\*Seat placement is determined as if outside the unit looking in. For clarity, a right hand model is shown in all drawings.

## Optional/Standalone Accessories†

|                                      |                         |                                     |                        |
|--------------------------------------|-------------------------|-------------------------------------|------------------------|
| <input type="checkbox"/> CR6001T     | Thru-bolted Curtain Rod | <input type="checkbox"/> SB1800T    | 18" grab bar           |
| <input type="checkbox"/> EF-4872-SC  | Shower Curtain          | <input type="checkbox"/> SB2400T    | 24" grab bar           |
| <input type="checkbox"/> EF-0000-SD  | Recessed Soap Dish      | <input type="checkbox"/> LB2156T    | 21"x56" L-bar          |
| <input type="checkbox"/> EF-0000-CCS | Composite Corner Shelf  | <input type="checkbox"/> RS21155    | 21"x15.5" Folding seat |
| <input type="checkbox"/> EF-0000-SK  | Shower Slide-Bar Kit    | <input type="checkbox"/> EF-0060-ED | T-Shaped EverDam       |
| <input type="checkbox"/> EF-0000-DA  | Shower Drain            |                                     |                        |

†If applicable, please select accessory style and finish from options below. If non-standard accessory is selected, please also indicate desired location(s) on drawing.

## Accessory Style

- Thu-bolted (Standard)  
 Flanged  
 Anti-ligature



Affordable Housing  
**SHOWERS.com**  
 by ORCA HealthCare

[www.affordablehousingshowers.com](http://www.affordablehousingshowers.com)

Quotes and inquiries:

1-888-286-8030

info@affordablehousingshowers.com

## Accessory Finish

- Satin Stainless (Standard)  
 Matte Black  
 Polished Stainless  
 White  
 Custom, please specify: